



Graduate Student Orientation at the John A. Burns School of Medicine

Mariana Gerschenson, Ph.D.

Associate Dean for Research and Professor

Email: gerschen@hawaii.edu

Phone: 808-292-9085 cell

Office is in BSB 211B, Lab is in BSB 203

AUGUST 29, 2024



Schedule for Today's Orientation

I. PHOTOS and Media Team: Matthew Campbell

II. Introduction and Welcome:

Drs. Mariana Gerschenson, Lee Buenconsejo-Lum,
and Julie Maeda

III. Wellbeing and Resilience: Tracie Ann Tjapkes

IV. Parking, IDs, and Safety: Elwyn Watkins

V. Environmental Health and Safety: Lisa Johns

VI. JABSOM Library: Melissa Kahili-Heede

VII. Graduate Student Bingo: Dr. Michelle Tallquist

JABSOM Graduate Student Web pages

Graduate school is full of opportunity! Surveyed graduate students from our programs have reported receiving strong mentoring and strong satisfaction with their learning experience. We are excited to welcome you to join our programs and contribute meaningfully to their success and continual revitalization. Below are common practical resources to help you as you orient yourself to your program.

Mariana Gerschenson, Ph.D.

Associate Dean for Research & Professor

Email: gerschen@hawaii.edu

Phone: (808) 692-1518



**JABSOM Graduate
Student Orientation
(pdf)**



**Access, Security, Fire
Safety, Parking (pdf)**



**Environmental Health
and Safety (pdf)**

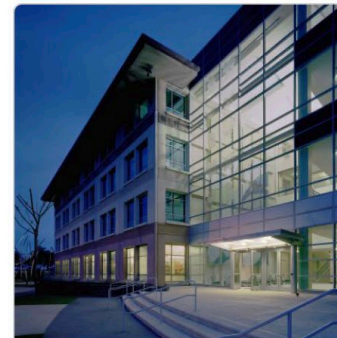

Health Sciences Library

<https://jabsom.hawaii.edu/research/trainees/masters-phds-trainees/index.html>







JABSOM Students and Faculty

Students (AY 2022-2023)



Medical Students

MD Students Total Enrolled: **320**

Approximate Annual MD applicants: **2,380**

MD New Entrants First-Year Class: **77**

Medical School Alumni (MD and Resident): **> 4,000**

'Imi Ho'ōla Post-Baccalaureate Program: **12**



Graduate Students - Master of Science (MS) or Doctor of Philosophy (PhD)

Biomedical Sciences (Tropical Medicine) (MS, PhD): **10, 14**

Cell & Molecular Biology (MS, PhD): **9, 19**

Quantitative Health and Clinical Translational Research (MS): **6**

Developmental & Reproductive Biology (MS, PhD): **5, 10**

Communication Sciences & Disorders (MS): **21**



Bachelor of Science (BS) or Other Programs and Certificates

Medical Technology (BS): **26**

Medical Technology Post-Baccalaureate Program: **24**

Graduate Certificate in Tropical Medicine (GCERT): **9**

Graduate Certificate in Clinical Research (GCERT): **5**

Graduate Medical Education Residents and Fellows: 228

Faculty (AY 2022-2023)



Full-time faculty employed by JABSOM alone or in combination with an affiliated academic faculty practice: **252**

Full-time Faculty (Basic Sciences): **43**

Full-time Faculty (Clinical Program): **209**

Part-time Faculty (Basic Sciences): **2**

Part-time Faculty (Clinical Program): **65**

Volunteer Faculty (Basic Sciences): **5**

Volunteer Faculty (Clinical Program): **1,695**

About

The University of Hawai'i Mānoa (UHM) John A. Burns School of Medicine (JABSOM) is led by T. Samuel Shomaker, MD, JD, MSM.

The Office of the Dean directs activities, personnel, and curricula in the School of Medicine and affiliated community hospitals and health centers. It is responsible for the direct liaison with other Schools of the College of Health Sciences and Social Welfare, the Graduate Division, community colleges, and community agencies for collaborative instruction, research, and community service. It establishes policies with the Schools' Executive Committee to develop and implement the academic programs and coordinate continuing medical education, conducts accredited graduate medical education programs in community hospitals, and is responsible for general program development in accord with Legislative mandate and University of Hawai'i policies.

Reach the Executive Assistant [April McConnell](#) at (808) 692-0881.



T. Samuel Shomaker, MD, JD, MSM.
Dean



Executive Team



Lee Ellen Buenconsejo-Lum, MD, FAAFP
Associate Dean for Academic Affairs & Professor



Nancy Foster, EdD, MA, CGMA
Associate Dean for Administration, Finance, and Operations and Chief Financial Officer



Mariana Gerschenson, PhD
Professor, Associate Dean for Research



GRADUATE DIVISION

UNIVERSITY OF HAWAI'I AT MĀNOA

GRADUATE PROGRAMS

ADMISSIONS ▾

CURRENT STUDENTS ▾

FINANCIAL SUPPORT ▾

FORMS



Graduate Division

[Home](#) » Graduate Division

Interim Dean and Associate Dean



Graduate Dean

The Graduate Dean is in charge of the overall management of the Graduate Division. She oversees the proposal and implementation of improvements in graduate education, including the development and supervision of graduate programs and courses, the appointment and evaluation of graduate chairs and faculty, as well as policies and procedures for graduate assistants and the monitoring of graduate fellowships. The Graduate Dean also chairs the Graduate Council and advises the officers of the Graduate Student Organization.

ENROLL AT THE UNIVERSITY OF HAWAI'I
AT MĀNOA NOW!

[Apply Here!](#)

<https://manoa.hawaii.edu/graduate//>

New Graduate Student Orientation 2024



Congratulations on your acceptance to the University of Hawai'i at Mānoa (UH Mānoa)! Your journey to an advanced degree begins now! Graduate Division is excited to welcome you and invites you to attend New Graduate Student Orientation (NGSO). Participating in NGSO is a great opportunity to prepare for a successful graduate student experience. Session topics include learning about what to expect in grad school, developing good relationships with mentors, planning for funding opportunities, and much more.

Please continue to check this NGSO webpage for updates throughout the summer. For any questions, please email gdevents@hawaii.edu.

<https://manoa.hawaii.edu/graduate/new-graduate-student-orientation-2024/>

Types of Support and Pay

- Graduate Research Assistant: You are doing research on a research grant/contract. You get a tuition waiver.
 - <https://manoa.hawaii.edu/graduate/graduate-assistants/>
- Graduate Teaching Assistant: You are either teaching a course or assist in teaching a course. You get a tuition waiver. You can get summer overload.
- Research Assistant: You are a technician on a research grant/contract employed by RCUH. RCUH may reimburse you for your classes. (<https://www.rcuh.com>)

<https://www.governmentjobs.com/careers/hawaiiedu?keywords=graduate%20assistant>

<https://sece.its.hawaii.edu/sece/login;jsessionid=CDE54CF978D2B60777B67AA31E93>



GRADUATE DIVISION

UNIVERSITY OF HAWAI'I AT MĀNOA

[GRADUATE PROGRAMS](#)[ADMISSIONS](#) ▾[CURRENT STUDENTS](#) ▾[FINANCIAL SUPPORT](#) ▾[FORMS](#)

Graduate Student Organization

[Home](#) » [Graduate Student Organization](#)

The purpose of the [Graduate Student Organization](#) (GSO) is “to provide classified graduate students, through the graduate programs, with official representation at the University of Hawai'i at Mānoa” (Constitution of the GSO). Its primary functions are:

- To provide input on policies affecting graduate students,
- To act as an advisory body to the Graduate Dean,
- To recommend graduate student representatives for service on campus-wide committees, and

**ENROLL AT THE UNIVERSITY
OF HAWAI'I AT MĀNOA NOW!**

[Apply Here!](#)

UPCOMING EVENTS

**Fulbright Webinar: Arts
Polishing Application
Webinar**

August 26 @ 8:00 am -
9:00 am HST

Fulbright Webinar:

What does the JABSOM Associate Dean for Research do for Graduate Students?

- Responsible for graduate student enrollment and academic goals
- Problem Solving:
 - Academic
 - Financial
 - Human Resources: Title IX, Hostile Work Environment, Microaggression, Implicit Bias

Resources for Grievances, Conflict Resolution, and Complaints

Any questions or concerns may be directed to Associate Dean for Research Mariana Gerschenson at gerschen@hawaii.edu or 808-692-1518.

Grievances: <https://manoa.hawaii.edu/graduate/graduate-student-grievances/>

JABSOM Ombudsman: <https://ombuds.jabsom.hawaii.edu>

Anonymous complaints (via the University of Hawaii Whistleblower Hotline):
<https://secure.ethicspoint.com/domain/media/en/gui/40480/index.html>

Hostile work environment etc.: JABSOM Human Resources Lead, Kathy Matsumoto at morifuji@hawaii.edu or 808-692-1176

Discrimination in education: Deputy Title IX Coordinator for JABSOM, Corinne Seymour at cseymour@hawaii.edu or 808-692-1160

If you have a professionalism concern or question, you may [submit your concern or question anonymously on our survey](#).

<https://jabsom.hawaii.edu/research/trainees/masters-phds-trainees/index.html>

Department Chairs

- Takashi Matsui, MD, PhD, Anatomy, Biochemistry, and Physiology,
Phone: 808-692-1554, Email: tmatsui@hawaii.edu
- Olivier Le Saux, PhD, Cell and Molecular Biology,
Phone: 808-692-1504, Email: lesaux@hawaii.edu
- William Boisvert, PhD, Tropical Medicine,
Phone: 808-692-1567, Email: wab@hawaii.edu
- Eunjung Lim, PhD, Quantitative Health Sciences
Phone: 808-692-1817, Email: lime@hawaii.edu

Resources Serving Kaka'ako

- **Library and online resources**
- **Laboratory Cores**
- **UH Office of Research Services**
- **Environmental Health and Safety Office (Manoa is separate)**
- **Cafeteria**
- **Human Resources and Fiscal**
- **Parking and IDs (Manoa and BSB/MEB is separate)**
- **Student Lounge in MEB 313C**

JABSOM CORES

The John A. Burns School of Medicine is committed to the support and enhancement of crucial cores to encourage research.

The preeminent goal of a core is to provide excellent service to a growing cadre of investigators from an enlarging circle of departments and institutions. Cores aim to maintain growth and enhance sustainability of core services. Most cores have three primary goals: service, teaching, and creation of new knowledge. Each core provides access to the latest techniques required by investigators to support hypothesis-driven research. Cores develop and implement training and education workshops. Cores also develop innovative and improved techniques, new technologies or applications of expertise in its field. By centralizing services and resources within cores, researchers are more efficiently served and the use of equipment is maximized. Through the triad of service, education, and innovation, cores support investigators at the university and the wider research community in conducting research that seeks to gain new knowledge about diseases and facilitate translation.

Cores located at Kaka'ako

ABSL-3/BSL-3 Biocontainment Core

The Pacific Center for Emerging Infectious Diseases Research provides an ABSL-3/BSL-3 Biocontainment Core. Research on microbial agents, which cause lethal diseases in humans and for which effective drugs or preventive vaccines are not available, must be conducted by well-trained investigators in specially built, well-maintained laboratories. The BSL-3/ABSL-3 Biocontainment Core encourages investigators at the university and the wider research community.



Contact: Vivek R. Nerukar, PhD | nerukar@hawaii.edu | (808) 692-1567

Website: <http://pceidr.jabsom.hawaii.edu> – Biocontainment

Bioinformatics Core Facility

The Bioinformatics Core Facility serves as a centralized resource for providing expert and timely bioinformatics consulting, analysis, collaborative research, management, and training solutions for high-throughput data. The data include different kinds of "omics" data (e.g., genomics, transcriptomics, epigenomes, proteomics, metabolomics, metagenomics data), which are generated from a variety of platforms such as PCR, microarray, mass-spec, and so on. The core provides a high-level expertise in bioinformatics, ensuring

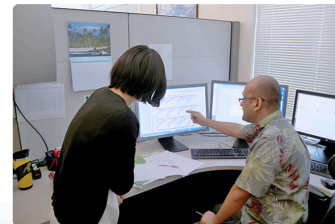

- <https://jabsom.hawaii.edu/research/cores/index.html>

Student Publication Fund



Student Publications Fund Created

For many of our student researchers, publishing fees for peer-reviewed publications can be very expensive. Thanks to generous donations, we created the [JABSOM Student Publications Fund](#) to assist our medical and graduate students in showing off the incredible research they are doing here at JABSOM.

- Peer-reviewed publication
- First or Second author or corresponding author
- \$1500.00 available/paper after the journal is paid.
- Must use personal funds to pay for the publication
- Must be a UH employee or student
- Application required
- Payment is based on funding availability
- <https://drive.google.com/file/d/1hmW9zCVC4f7bh97cb2vYv5BsDZMw5Gdn/view>

JABSOM Student Lounge (MEB 313C)



WELCOME



April 7 & 8, 2022

Abstract submission deadline extended to March 1, 2022

The Annual Biomedical Sciences & Health Disparities Symposium attracts some of the top health science research and ideas from throughout academia in Hawaii.



SCHEDULED: April 4 and 5th, 2025

[Home](#)[Counseling Services](#)[Testing Services](#)[Workshops, Consultation
and Outreach](#)[Doctoral Internship for
Health Service Psychology](#)[Counselor-In-Residence
\(CIR\) Program](#)[Psychotherapy Practicum](#)[Peer Fellow Program](#)[About CSDC / Staff](#)[Meet the Staff](#)[Contact Us / Location](#)[Appointments / How to
Obtain Services](#)[Locating Help and
Resources](#)

The [Assisting Students in Distress: Green Folder Project](#) is a quick reference guide for faculty and staff on how to recognize, support, and refer distressed students. To request hard copies for your department, please complete our [Google form](#).



Counseling and Student
Development Center
(CSDC)
Queen Lili'uokalani Center
for Student Services
Room 312

Phone: (808) 956-7927

**Follow us on Social
Media**



CSDC Office Hours

Monday - Friday
8:00 a.m. - 4:30 p.m.

*Appointments begin at 8:30
a.m.*

Urgent or **crisis** services are
available daily 8:30 a.m. to
3:30 p.m. hours. ([view map](#))

(For crises / emergencies
[after hours, click here](#))

About Us

Our Mission

The Counseling and Student Development Center, a unit within the Office of the Vice-Chancellor of Student Affairs (OVCS), has as its overall mission the provision of high quality services to promote the academic success and well-rounded development of students and members of the broader University community. Our services are oriented toward the individual needs of students using a whole person developmental perspective. We facilitate the acquisition of skills, awareness and knowledge that students use to meet and integrate the demands of their academic, personal and social pursuits. In carrying out this mission, the Center is responsive to the diversity inherent in our uniquely international and multicultural island community.

As a multi-faceted Center, we embrace an integrated philosophy which links counseling, testing, psychiatric and training services as well as collaboration with other campus and community resources. The Center works towards this end as a team of professionals using a variety of approaches, styles, methods, and programs designed to empower students to accomplish their developmental tasks in positive learning environment. We recognize that our ability to be responsive to the needs of the campus community is based on a continuous commitment to organizational integrity, professional development, and personal growth.

<https://manoa.hawaii.edu/counseling/about/>

Thank you! Questions?

